



MM9046-XX

REGULATED DC POWER SUPPLY

FEATURES

- Provides a Regulated DC Voltage Output
- Short Circuit Protected
- $\pm 15\%$ Adjustable Output
- 10 Year Warranty

DESCRIPTION

The MM9046-XX Power Supply is a well regulated supply designed to power two-wire transmitters, digital panel meters, strain gauges, and other devices requiring regulated DC power. Ten modules are available.

TYPICAL APPLICATIONS

Power for two-wire transmitters, strain gauges, etc.

SPECIFICATIONS

INPUT

Voltage

115 VAC $\pm 10\%$, 50 or 60 Hz
230 VAC $\pm 10\%$, 50 or 60 Hz
Available

OUTPUT RANGE

5 V - 36 VDC
(See list in Ordering Information)

NOISE & RIPPLE

0.003% of output

REGULATION

Line

0.04%/V

Load

(0-100%)

0.05%

OPERATING TEMPERATURE

14°F to 140°F / -10°C to 60°C

TEMPERATURE STABILITY

$\pm 0.02\%$ of span / °C max

ORDERING INFORMATION

POWER

- 115 VAC, 50/60 Hz Power
- 230 VAC, 50/60 Hz Power

OUTPUT

- 36 V 40 mA
- 32 V 40 mA
- 28 V 60 mA
- 24 V 60 mA
- 18 V 65 mA
- 15 V 65 mA
- 12 V 85 mA
- 9 V 120 mA
- 6 V 120 mA
- 5 V 200 mA

OPTIONS

- Conformal Coating

TAGS

Specify Tag Numbers

Tag Number is typed on product label at no charge.

Enter Tag Number(s)

ACCESSORIES

MM9046

DR1	DIN-Rail, 35 mm Symmetrical, 39 inches (1 meter)	Qty _____
MP008	Plastic Socket, 8-pin, for Flat Surface or PVC Track	Qty _____
TRK48	PVC Snap-Track, 4 ft, for MP008, MP011, & DMP8500	Qty _____
DMP008	DIN-Rail Mounting Socket, 8-pin, 35 mm Symmetrical Rail	Qty _____
CLP1	Holddown Assembly for MP008 and MP011	Qty _____
HKB-HK2D-8	Explosion-Proof Housing with MP008 Installed	Qty _____

DIMENSIONS

Inches [mm]

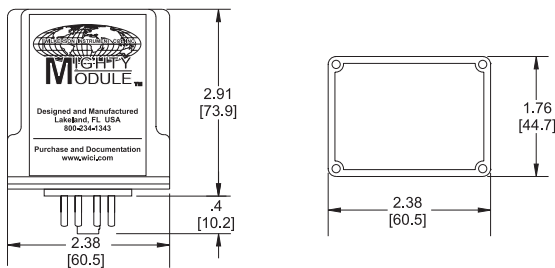

CONNECTIONS

PIN 1	Power AC L1
PIN 3	Power AC L2
PIN 7	Output +
PIN 8	Output -



2915 Parkway Street
Lakeland, FL 33811-1391 · USA
800-234-1343
Tel: 863-647-2000 · Fax: 863-644-5318
www.wici.com · Email: sales@wici.com