



MM7010

FREQUENCY INPUT TRANSMITTER

FEATURES

- Provides DC Output Proportional to Frequency Input
- Fully Isolated Output Available
- Frequency Limit 60 kHz
- 50 mV to 100 V Peak Input Sensitivity
- Adjustable Threshold for Low Level Noise Rejection
- Input Pullup Resistor Available
- Unlimited* Choice of Input/Output Ranges
- Choice of Power Options
- 10 Year Warranty

DESCRIPTION

The MM7010 provides a DC output voltage or current proportional to the frequency of the input signal. It is useful for measuring flow, speed of motors, conveyors, or other devices that can create a periodic signal proportional to the desired function. The wide range of input sensitivity allows the MM7010 to be driven from low level magnetic pickups as well as logic level signals.

A threshold adjustment sets the minimum input amplitude the module will process. This allows the user to trade off sensitivity versus noise rejection. An optional pullup resistor (Option P) permits use with contact closure or open-collector inputs.

All Wilkerson products are designed with RFI filters and lightning protection to reduce susceptibility to electrical noise and damage by lightning.

TYPICAL APPLICATIONS

Measuring or monitoring flow, speed of motors, conveyors, etc.

SPECIFICATIONS

INPUT RANGE

select any range from
0 to 10 Hz min to 0 to 60 kHz max

INPUT SENSITIVITY (Threshold)

any voltage from 50 mV
to 100 V peak

INPUT IMPEDANCE

100 kilohms

OPTION P

10 kilohms pullup resistor
to +6.5 V

OUTPUT RANGE

Voltage
select any range from
-10 V to +15 V,
10 mA max load
(min span 0.2 V)

Current
select any range from
0 to 50 mA max, >24 V
compliance
(1200 ohms max at 20 mA)
18 V compliance for ISO option
if full-scale output >20 mA

ACCURACY

±0.1% of span

LINEARITY

±0.1% of span

COMMON MODE REJECTION

120 dB, DC to 60 Hz

ISOLATION

(Optional)
Output / Input
>500 megohms
Breakdown Voltage
>1000 VAC rms
Breakdown, Power / Circuitry
>1500 VAC rms

OPERATING TEMPERATURE

14°F to 140°F/-10°C to 60°C

TEMPERATURE STABILITY

±0.02% of span/°C max

POWER

115 VAC ±10%, 50/60 Hz
(2.5 W max)

230 VAC ±10%, 50/60 Hz
(2.5 W max)

(DC Power Option)

24 VDC (limits 21-32 VDC)

12 VDC (limits 10-16 VDC)

* Within specified range limits

ORDERING INFORMATION

POWER

- 115 VAC, 50/60 Hz Power
- 230 VAC, 50/60 Hz Power
- 24 VDC Power, Transformer Isolated
- 12 VDC Power, Transformer Isolated

INPUT

Select Units

- Hz KHz

Enter Input

Full Scale

OUTPUT

Select Units

- VDC mADC

Enter Output

Zero Scale

Full Scale

OPTIONS

- Isolated Output
- Conformal Coating

TAGS

Specify Tag Numbers

Tag number is typed on product label at no charge.

Enter Tag Number(s)

ACCESSORIES

MM7010

DR1	DIN-Rail, 35 mm Symmetrical, 39 inches (1 meter)	QTY _____
MP008	Plastic Socket, 8-pin Panel Mount or PVC Snap Track	QTY _____
TRK48	PVC Snap-Track, 4 ft. (MP008, MP011 & DMP8500)	QTY _____
DMP008	DIN-Rail Mounting Socket, 8-pin, 35 mm Symmetrical Rail	QTY _____
CLP1	Holddown Assembly for MP008 and MP011	QTY _____
HKB-HK2D-11	Explosion-Proof Housing with MP008 Installed	QTY _____

DIMENSIONS

Inches [mm]

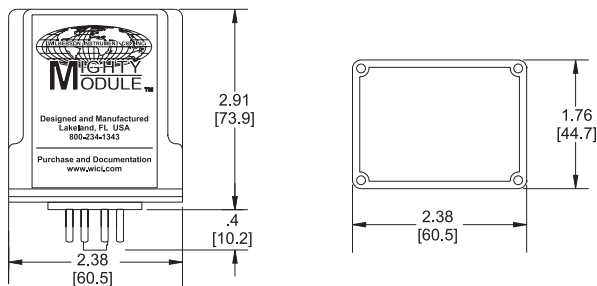

CONNECTIONS

- PIN 1 Power AC L1 or DC +
- PIN 2 No Connection
- PIN 3 Power AC L2 or DC -
- PIN 5 Input +
- PIN 6 Input -
- PIN 7 Output +
- PIN 8 Output -



 2915 Parkway Street
 Lakeland, FL 33811-1391 · USA
800-234-1343
 Tel: 863-647-2000 · Fax: 863-644-5318
www.wici.com · Email: sales@wici.com